

The Wexford



Independent Living

1515 West 28th Street
Loveland, Colorado 80538

970-667-1900

40 PLUS YEARS OF CARING FOR SENIORS!

www.columbinehealth.com

OUR MONTHLY RENT INCLUDES:

- Various apartment styles to choose from- (studio, one bedroom, one bedroom with den and two bedroom with either one or two baths)
- Daily breakfast buffet
- Daily lunch and dinner served by attentive waitstaff
- Housekeeping and linen service each week
- Complimentary personal laundry facilities
- Scheduled transportation available by fleet transportation service (doctor visits, shopping, errands, and activities)
- Activities and recreation program
- Call system to alert staff at front desk of emergencies 24 hours a day, 7 days a week
- Small pets allowed
- Building and private residence maintenance
- Mailboxes and message center
- Real estate taxes and insurance (except personal property)
- Parking space for your car
- All utilities (except phone)



COMMENTS FROM OUR RESIDENTS & THEIR FAMILIES

“The Wexford is a community... like an unrelated family.” - Current Resident

“Joining Dad for meals at The Wexford is a treat. He is happy there and independent.” - Family Member

“The well-maintained facilities, the helpful staff, and the fun activities give my Mom a healthy and cheerful outlook on life. A happy Mom is a good thing!” - Family Member

AMENITIES AVAILABLE FOR AN ADDITIONAL FEE:

- Beauty and barber shop
- Guest apartment
- Guest meals
- Garages
- Extra meals in dining room

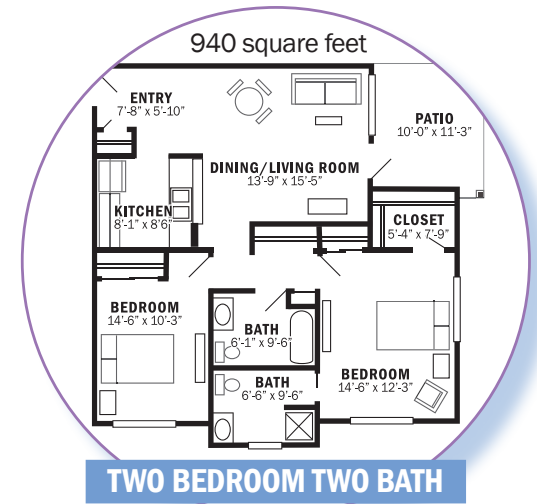
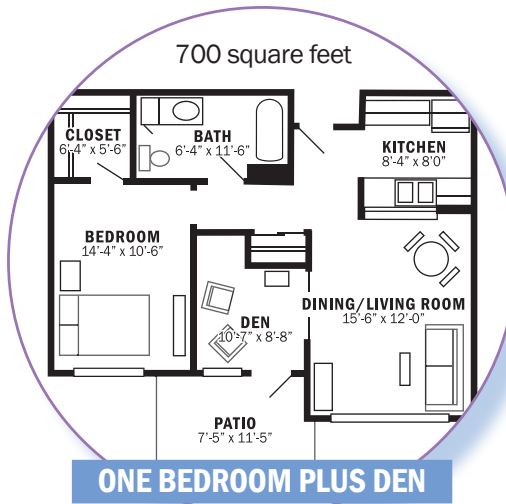
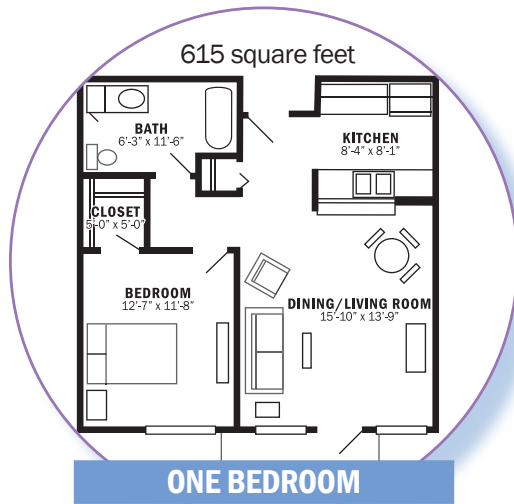

INDEPENDENT LIVING FACILITY **IN THE COLUMBINE HEALTH SYSTEM**

Choosing independent living offers a lifestyle where housework, yard maintenance, snow removal, trash service, and meal preparation are a thing of the past.

Socialization and camaraderie with peers is the focal point of living in an independent living environment.

Our location, on the northwest corner of Lake Loveland, near the Benson Park, affords our residents many opportunities for recreation, exercise, and leisure pursuits.

Loveland is located near the mouth of the Big Thompson Canyon, which leads to Estes Park and Rocky Mountain National Park. Loveland offers local attractions including the Civic Center, three beautiful golf courses, the Loveland Chamber Orchestra, the Rialto Theater, the Loveland Museum/Gallery, the Loveland Public Library, Boyd Lake State Park, miles of paved trails for walking and bike riding, numerous city parks, and annual events within the community.

The Loveland Campus of Columbine Health Systems is proud to offer an array of services to our residents, as well as, the community. Columbine Health Systems offers a home care agency, medical equipment company, independent living facilities, assisted living facilities, skilled nursing facilities, dementia care, and hospice care.

Choosing The Wexford affords an opportunity to utilize the services and facilities offered in our campus continuum.

Locally owned and operated since 1971



Columbine Management Office

802 West Drake Road, Suite 101
Fort Collins, Colorado 80526
970-482-0198 Fax: 970-482-9148
www.columbinehealth.com

● REHABILITATION | ● HEALTH & REHAB | ● HEALTH SERVICES
● INDEPENDENT LIVING | ● ASSISTED LIVING | ● PATIO HOMES

FORT COLLINS

- Bloom at Home 970-482-5096
- Centre Avenue Health & Rehab Facility.....970-494-2140
- Centre Pharmacy, Inc.....970-221-0190
- Columbine Medical Equipment.....970-221-1453
- Columbine Poudre Home Care 970-482-5096
- Columbine West Health & Rehab Facility ... 970-221-2273
- Front Range Therapy 970-494-6449
- Geriatric Education Centre..... 970-494-6455
- Lemay Avenue Health & Rehab Facility.....970-482-1584
- Lifestyle Centre..... 970-494-6446
- New Mercer Commons970-495-1000
- Poudre Infusion Therapy.....970-494-2130
- The Winslow 970-492-6200
- The Worthington 970-490-1000

LOVELAND

- Bloom at Home 970-482-5096
- Front Range Therapy 970-494-6449
- Lakeview Commons.....970-278-4000
- North Shore Health & Rehab Facility970-667-6111
- Centre Pharmacy, Inc.....970-221-0190
- Columbine Medical Equipment.....970-221-1453
- Columbine Poudre Home Care 970-482-5096
- Poudre Infusion Therapy.....970-494-2130
- The Wexford970-667-1900

WINDSOR

- Bloom at Home 970-460-9200
- Centre Pharmacy, Inc.....970-221-0190
- Columbine Commons 970-449-5540
- Columbine Commons Health & Rehab Facility .. 970-449-5541
- Columbine Medical Equipment 970-460-9205
- Columbine Poudre Home Care 970-460-9200
- Front Range Therapy 970-494-6449
- Poudre Infusion Therapy..... 970-460-9208
- Westwood Patio Homes 970-460-5000